

## KeyCreator Lesson KC4501 Fixture Plate

Let's create the simple fixture plate illustrated to the right to expose you to some basic two-dimensional construction tools.

We'll start with a new file in View 1. (The Top View.)

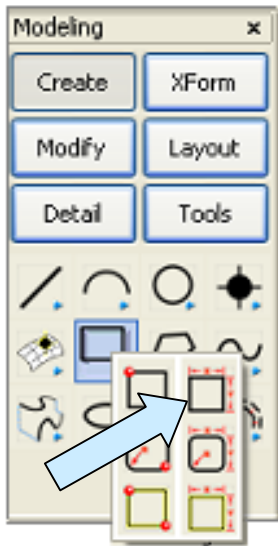
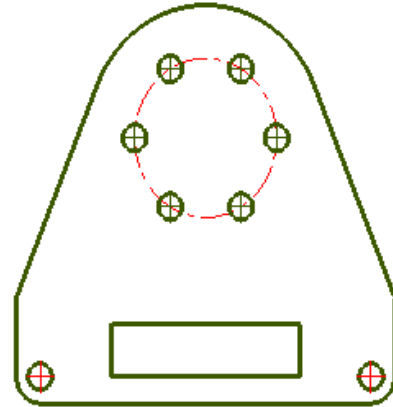

Click on the CREATE RECTANGLE BY WIDTH HEIGHT Icon. Use the MidCtr Anchoring Option.

Type 4 for the width and 1 for the height. Click on the Keyin Option and hit the ENTER Key three times to center the rectangle on the origin of the file.

Click on the Backup Button on the Conversation Bar and enter 2 for the width and 0.5 for the height. Use the Keyin Option again and hit the ENTER Key three times.

Your screen should now look like this:

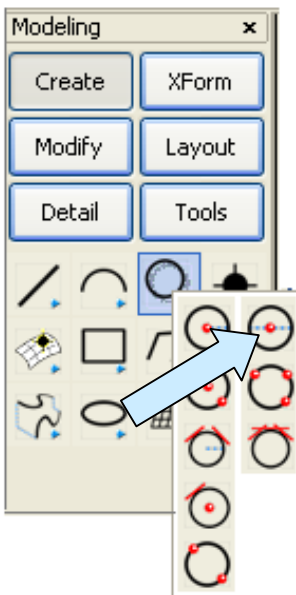

Click on the CREATE CIRCLE BY DIAMETER Icon.

Type 2.5 for the diameter and click on the Keyin Option.

Use 0 for the XC value, 2 for the YC value, and 0 for the ZC value.

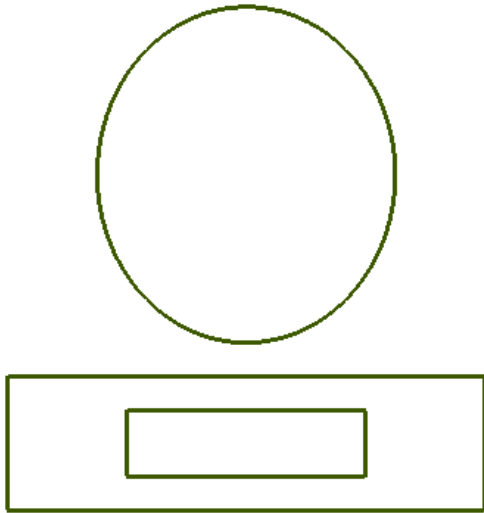

Your screen should look like this:

Click on the Backup Button on the Conversation Bar.

Type 1.5 for the diameter.

Now use the CtrMid Option and click on the first circle that you made. This places the second circle concentric to it.

Now click on the CREATE LINE TAN THROUGH A POSITION Icon.

Click on the larger circle at the 10:00 O'Clock position and then using the EndEnt Option, click on the top, left corner of the rectangle.

Click once on the Backup Button and then repeat this process, clicking on the larger circle at the 2:00 O'Clock position and then using the EndEnt Option on the top, right corner of the rectangle.

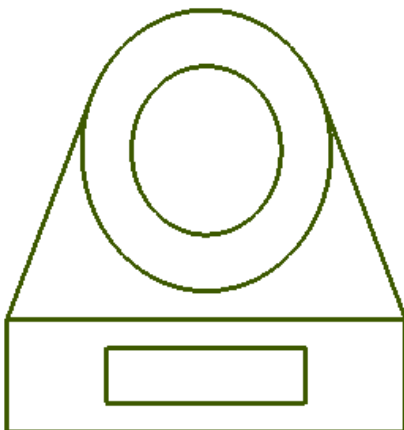
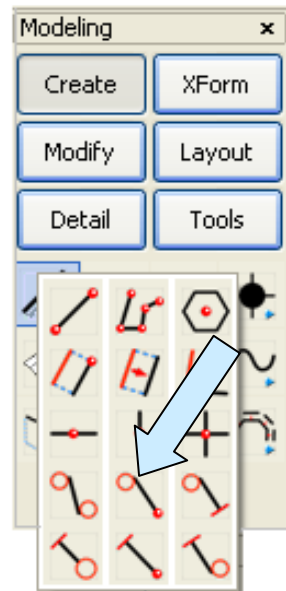

Your screen should now look like this:

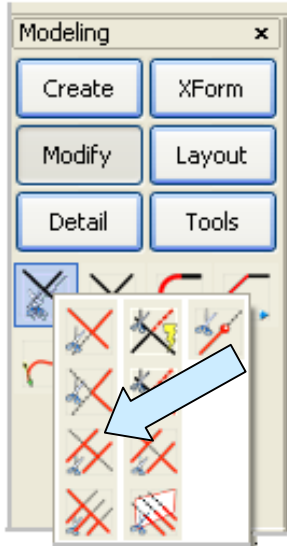

Click on the TRIM DOUBLE Icon.

Now, click on the top part of the larger circle and then on each of the oblique lines that are tangent to it.

Next, click on the MULTIPLE DELETE Icon.

Click on the top edge of the large rectangle and hit the ENTER Key.

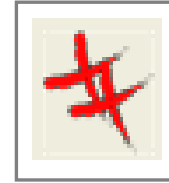

Your screen should now look like this:

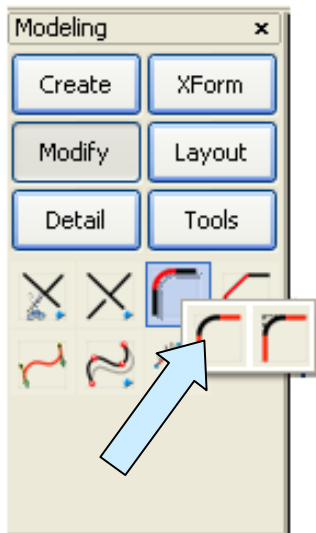
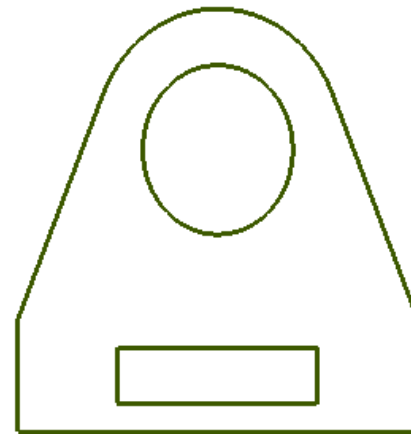

Click on the FILLET WITH TRIM Icon.

Type 0.25 for the radius and create fillets at the two bottom corners of what was the large rectangle.

Your screen should now look like this:

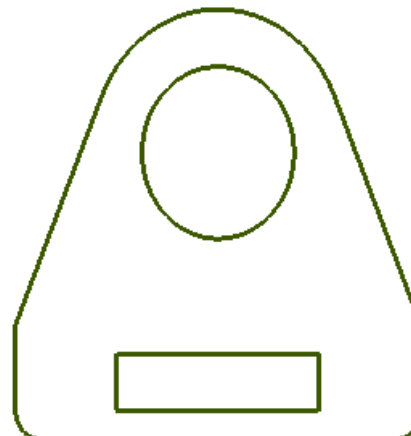

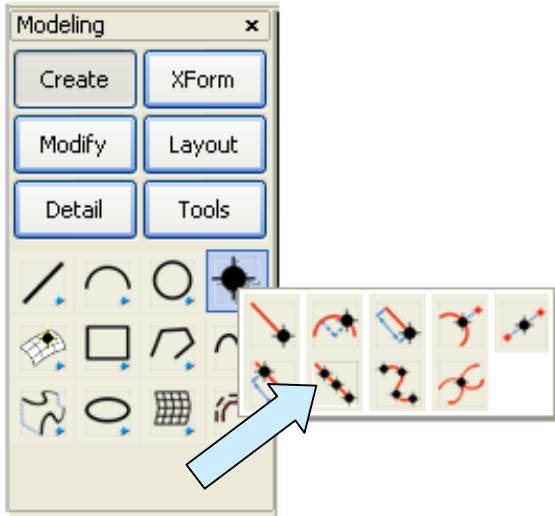

Click on the CREATE NUMBER OF SPECIFIED POINTS Icon.

Type 6 for the number and select the 1.5 diameter circle.

This creates six points spaced 60 degrees apart on the circle.

Click on the CREATE CIRCLE BY DIAMETER Icon.

Type 0.25 for the diameter.

Using the CtrMid Option, click on each of the 0.25 fillets at the bottom corners of the part.

Then, using the Point Option, click on each of the points that you made on the 1.5 diameter circle.

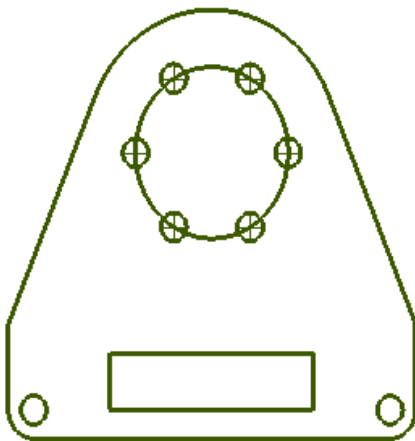
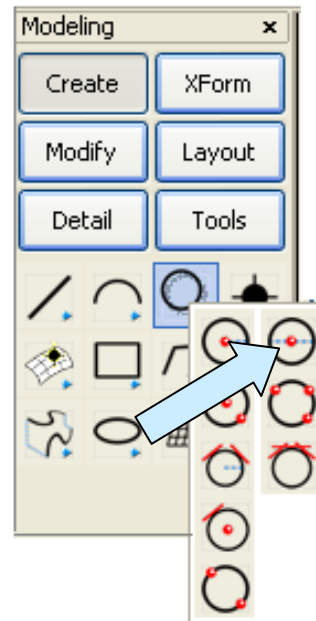

Your screen should now look like this:

Click on the CHANGE ATTRIBUTE Icon.

A Dialog Box appears. Select a new color and the centerline line style. Then, click on the 1.5 diameter circle and hit the ENTER Key.



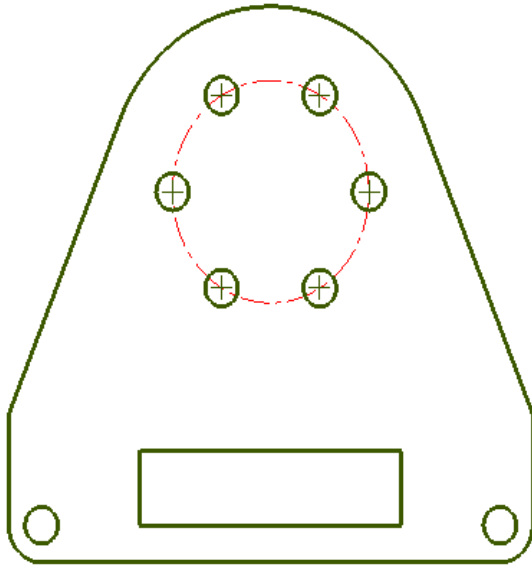

Your final construction should look like this:

Save this file. Let's call it "KC4501."